

ORTHORA 200

EQUIPMENT

2402

CONSULTANT

DISTRIBUTOR

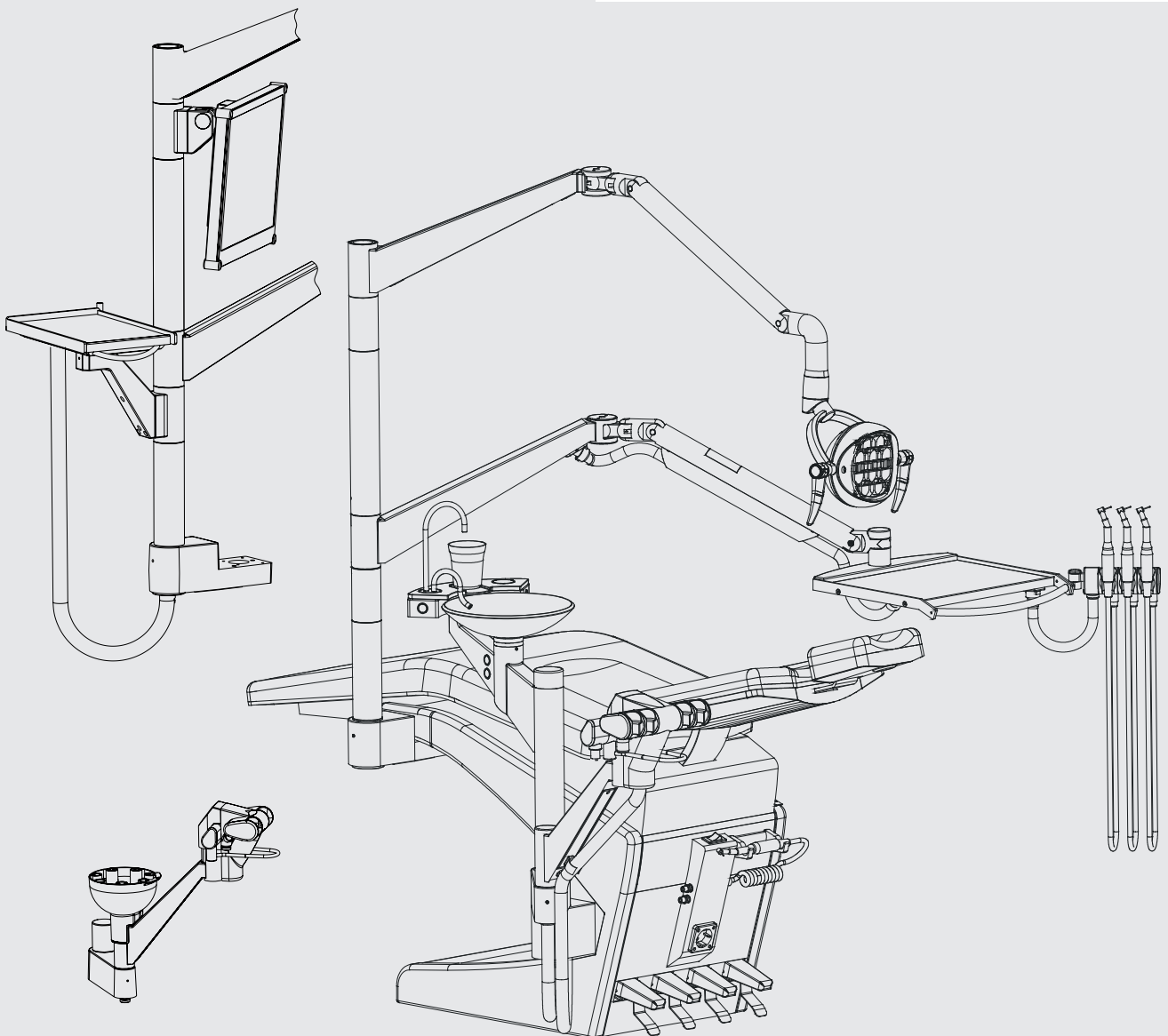

Operation	Voltage	Socket system	Color	Upholstery	Aspirator
<input type="checkbox"/> Right-handed person <input type="checkbox"/> Left-handed person	<input type="checkbox"/> 230V/50Hz <input type="checkbox"/> 100V/50Hz <input type="checkbox"/> 120V/60Hz	<input type="checkbox"/> Schuko <input type="checkbox"/> CH T13 <input type="checkbox"/> US/CAN <input type="checkbox"/> F/B	<input type="checkbox"/> RAL (Standard) RAL-No. _____ <input type="checkbox"/> Metallic (Surcharge) Description MIK _____	Upholstery Mikrona "T" <input type="checkbox"/> Standard <input type="checkbox"/> Memory Color: _____	<input type="checkbox"/> Dry aspirator syst. <input type="checkbox"/> Wet aspirator syst. <input type="checkbox"/> None

Re.Formance Line Working chair

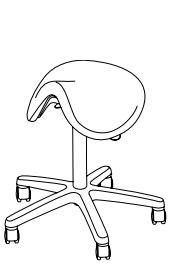

Re.Forma Hi.
Amount: _____

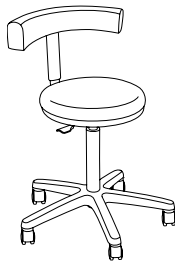

Re.Forma
Amount: _____



Re.Forma Lite.
Amount: _____

Standard
Black base

Options
 Chromed base
 Foot plate control for height adjustment (chromed)

Upholstery
 Leather upholstery like unit
 Leather upholstery _____

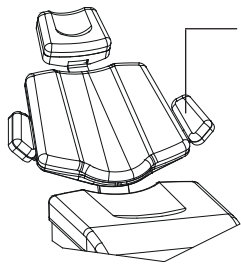

Armrest
 Yes
 No

Attention!
 For safety reasons the armrest may not be used in combination with ORTHODESK 320.6545.xx .

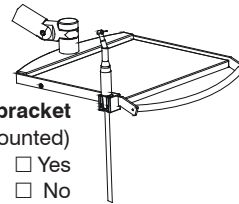

Instrument bracket
 (right or left mounted)
 Yes
 No

Instrument bracket with
 Micromotor MX & MX2
 Micromotor MC3 or turbine device
 Ultrasonic EMS
 Ultrasonic PIEZON
 3-Function syringe LUZZANI
 6-Function syringe LUZZANI

ORTHORACK

ORTHORACK Back-of-head instrument (BOH)

- BOH connected with OT200 unit
 - Air/water supply from OT200 unit
 - Air/water supply from BOH

Autonomous water supply

- Yes
- No

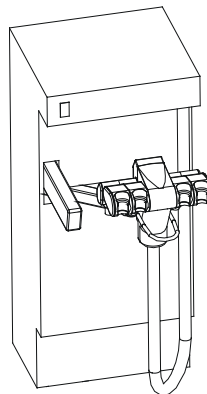
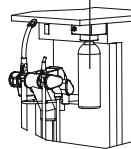

Rack with aspirator
 Yes OP-suction
 Saliva suction
 No

Instrument rack (max. 4 instr.)

- Micromotor MX2 LED
 - Instr. hose with water regulation
- Micromotor MC3 IR
- Micromotor MC3 LED
- Turbine device 4VLM LUX
- Ultrasonic PIEZON, EMS
- Ultrasonic NEWTRON, Satelec
- 3-Function syringe LUZZANI
- 6-Function syringe LUZZANI
- Polymerization lamp MINI LED ORTHO

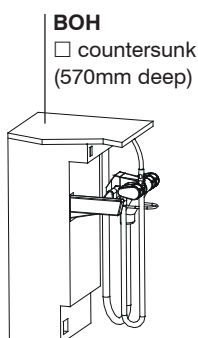
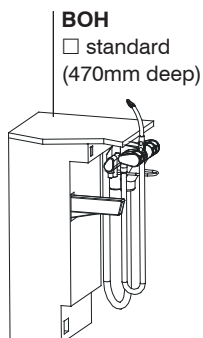

iPad-holder

on floating table

- iPad mini 1 / 2 / 3 / 4
- iPad Air2 & Pro9,7 & 9,7"
- iPad Pro 10,5" & Pro 11" (2018) & 10,2"

Multimedia

- Yes
- No

Adaptation

- LCD-Screen 22" on mounting rod
- Intraoral camera

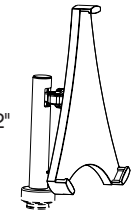

OP lamp

- Yes
- No

Lamp

- OP lamp LED MIKRONA (lamp case, RAL 9006)
 - sensor switch
- OP lamp arm extension
- Ceiling OP lamp LED MIKRONA (Polaris)
 - RAL 9002 RAL 9010 RAL 9016
 - customer specific finish
 - sensor switch
- ORTHOLUX 200 LED (ceiling model, color RAL 9002)

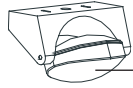

Floating table

- Yes
- No

Floating table

- without instrument bracket
- with instrument bracket VARIO

Instrument bracket (max. 3 instruments)

- Micromotor MX2 LED
 - Instr. hose with water regulation
- Micromotor MC3 IR
- Micromotor MC3 LED
- Turbine device 4VLM LUX
- Ultrasonic PIEZON, EMS
- Ultrasonic NEWTRON, Satelec
- 3-Function syringe LUZZANI
- 6-Function syringe LUZZANI
- Polymerization lamp MINI LED
- Rack for micro blaster
 - Microetcher Dento-Prep

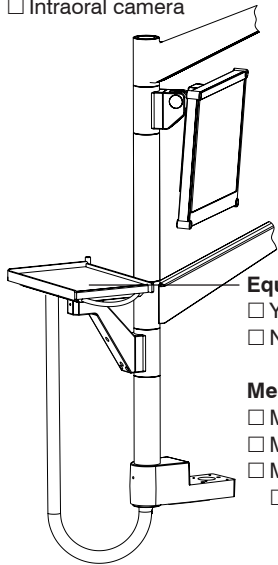

Equipment tray

- Yes
- No

Media supply

- Media supply 1
- Media supply 2
- Media supply 3
- Water from bottle system

Tray on comfort rack

- Yes
- No

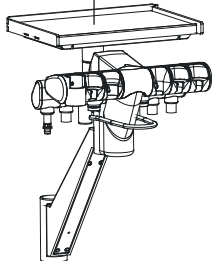

Spittoon

- with glass filler
 - Yes Glass bowl (standard)
 - Ceramic bowl (optional)
- No

Rack with aspirator

- Yes
 - OP-suction
 - Saliva suction
- No

Instrument rack (max. 4 instruments)

- Micromotor MX2 LED
 - Instr. hose with water regulation
- Micromotor MC3 IR
- Micromotor MC3 LED
- Turbine device 4VLM LUX
- Ultrasonic PIEZON, EMS
- Ultrasonic NEWTRON, Satelec
- 3-Function syringe LUZZANI
- 6-Function syringe LUZZANI
- Polymerization lamp MINI LED ORTHO, Satelec
- Rack for micro blaster
 - with air connection Microetcher
 - without air connection Dento-Prep

Water separation system

- Autonomous water supply
 - 0.8lt Bottle
 - 1.2lt Bottle
- Metasys water aseptic & separation system WEK (apparatus beside the chair)

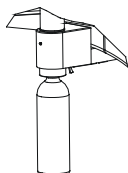

Instrument flushing

- CleanHub

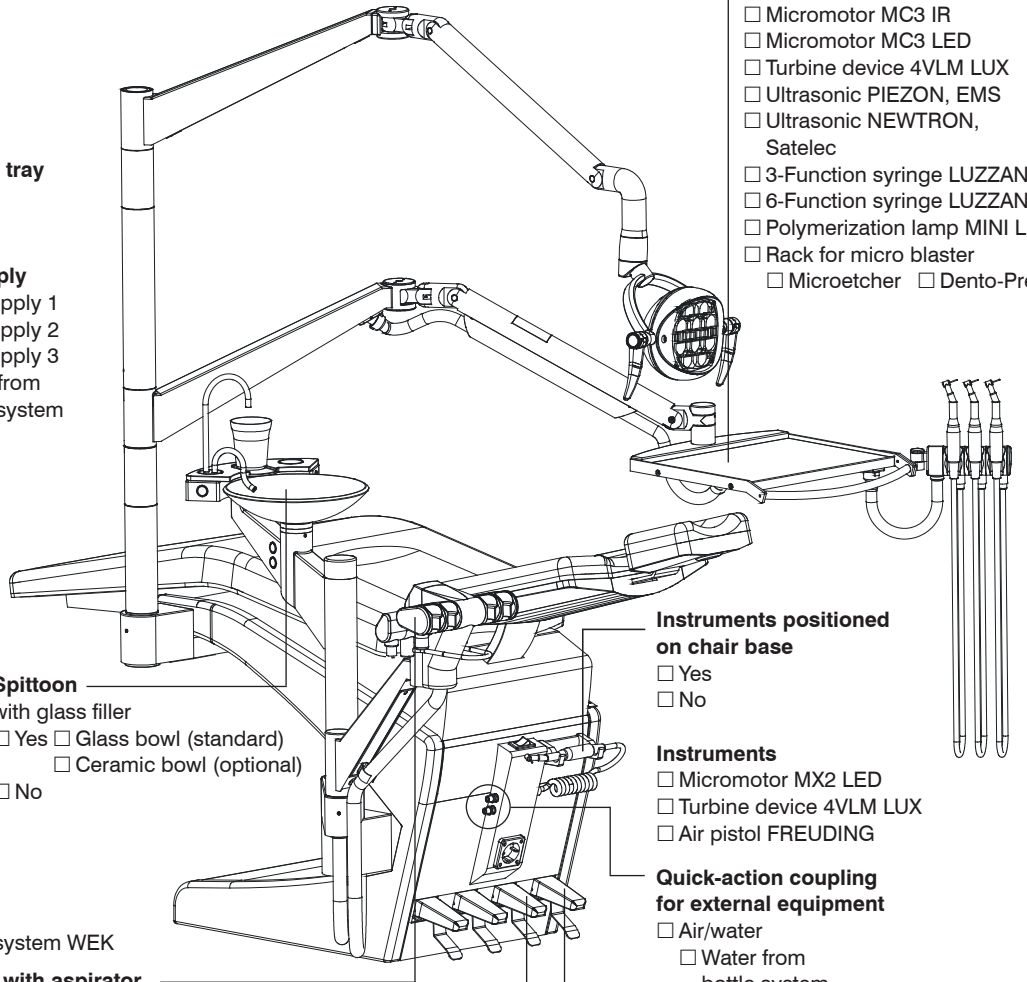
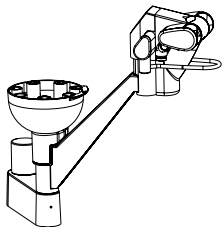

Instruments positioned on chair base

- Yes
- No

Instruments

- Micromotor MX2 LED
- Turbine device 4VLM LUX
- Air pistol FREUDING

Quick-action coupling for external equipment

- Air/water
 - Water from bottle system
- Air

Instrument operation

- 4-Function pedal DYN
- 5-Function pedal Pedal
 - built in (standard)
 - free standing (optional)

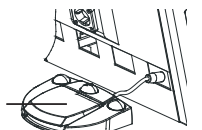

3-Function pedal for operating special functions

- Yes
- No

Operating functions

- ORTHOLUX 200
- OP lamp ON/OFF
- special functions

ORTHODESK

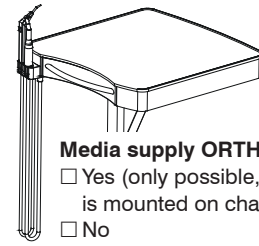
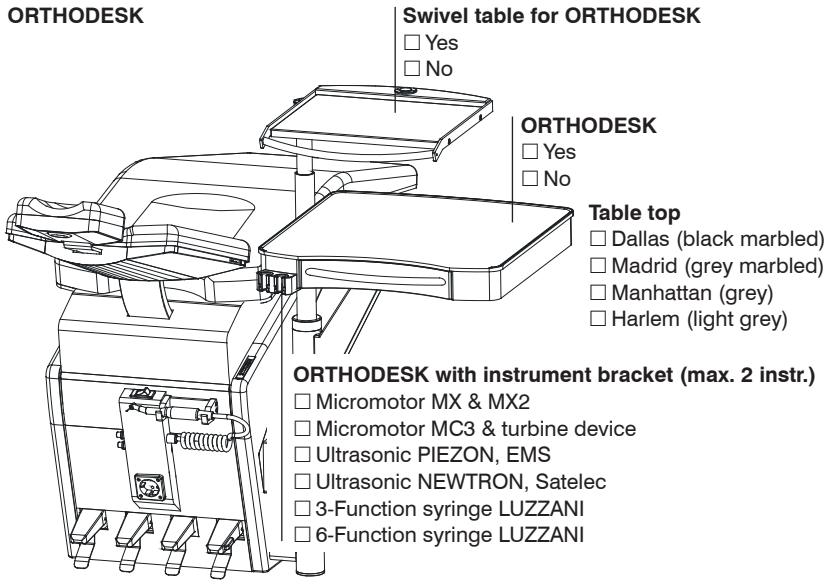

Media supply ORTHODESK

- Yes (only possible, if no instrument is mounted on chair base)
- No

Media supply (2 instruments)

- Micromotor MX & MX2
- Micromotor MC3 IR
- Micromotor MC3 LED
- Turbine device 4VLM LUX
- 3-Function syringe LUZZANI
- 6-Function syringe LUZZANI

max. 1 instr.

Date:

Signature: